

REV -  
SHT 1  
DWG NO. 302-0330-780

REVISIONS				
ZONE	REV	DESCRIPTION	DATE	APPROVED

**SCHEMATIC DIAGRAM:**

NOTE: MECHANICAL DIMENSIONS ARE IN INCHES

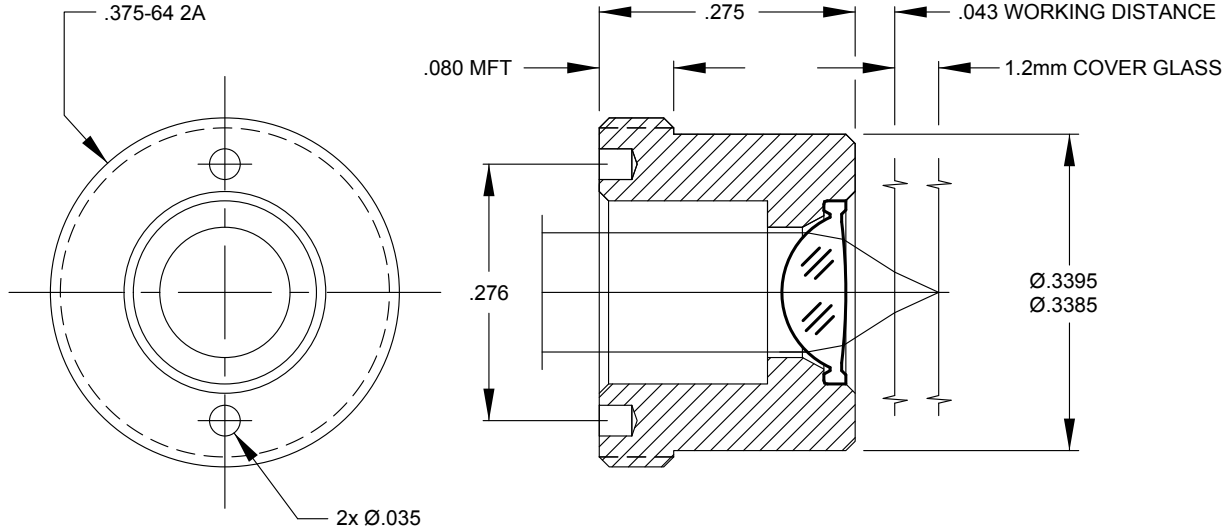

**SPECIFICATIONS:**

DESCRIPTION: OBJECTIVE LENS, PLASTIC ASPHERIC  
NOTE: SPECIFICATIONS ARE IN MILLIMETERS

- DESIGN WAVELENGTH: 785nm
- FOCAL LENGTH: 3.07mm
- NUMERICAL APERTURE: 0.53
- CLEAR APERTURE: 3.254mm
- F#: 0.943
- WORKING DISTANCE: 1.09mm
- IMAGE/OBJECT DISTANCE: INFINITE
- TRANSMISSION: >95%
- COVER GLASS THICKNESS: 1.2mm
- COVER GLASS REFRACTIVE INDEX: 1.57
- WEIGHT: <0.0326 grams
- WORKING TEMPERATURE: -10°C TO +65°C
- TYPICAL WAVEFRONT ABERRATION  
ON AXIS: <0.026 RMS @ 0.075mm IMAGE HEIGHT
- LENS HOLDER MATERIAL: ALUMINUM, BLACK ANODIZED

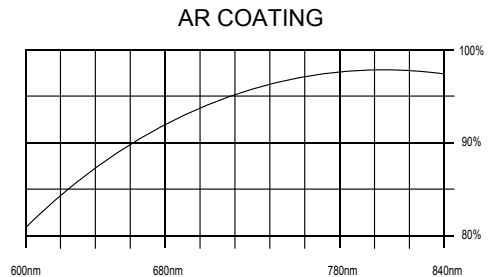

LENS TRANSMISSION VS. WAVELENGTH

CLASSIFICATION PRODUCTION	
CONTRACT/FILENAME 3020380.DWG	
DRAWN BY RS	DATE 10AUG15
APPROVED BY	DATE
TOLERANCES (DIMENSIONS IN INCHES)	
X.X = ±0.05	
X.XX = ±0.01	
X.XXX = ±0.005	
X.XXXX = ±0.0005	
ANGLE ±0.5 DEGREES	

<b>OPTIMA PRECISION INC.</b>			
<b>ASPHERIC PLASTIC OBJECTIVE LENS, MOUNTED</b>			
<b>A</b>	FMSC NO	DRAWING NO	REV
		<b>302-0330-780</b>	-
SCALE	5x	081015	SHEET 1 OF 1